

MAJESTIC PENTA CEILING FAN



Burnt Copper with Walnut blades

Installation Locations:

Indoor

Recommended Height:

There should be at least 2.1m between the lowest point of the fan blades and the floor.

Top of canopy cover to lowest point of the fan:

Approximately 380mm

Motor:

16 Pole, 188mm x 15mm motor
Made with the highest grade copper windings and silicone steel stator. Bearings are sealed to ensure quiet operation and long life.

Motor Housing:

Materials: Pressed Steel

Available Colours :

White, Brushed Chrome, Antique Brass & Burnt Copper

Blades:

Sizes: 1320mm (52")
Material: NZ Plywood with Rattan
(Flat colours are painted & lacquered ~ wood grain colours are laminated & lacquered)
Blade Pitch: 12°

Available Blade Colours:

White, Brushed Silver, Beech & Walnut

Extra Information:

Introduced into the HPI range in 2006
3 Speed Pull cord
Light Adaptable
Reversible
Wall control does not come standard

Standard Canopy Cover:

Suitable for flat and pitched ceilings up to 28°

Wall Controller Speed Capacitor Values:

4.3µF & 2.1µF

Rotational Diameter:

1320mm (52") Blade Sweep

Weight Including Packaging:

Complete Fan 1320mm (52"): 10.3kg

Packaging Dimensions (cm):

Complete fan 1320mm (52"): 52L x 38W x 28H

Accessories:

Remote Control
Extension Down Rod 21mm diameter
45° Ceiling Kit (for pitched ceilings)
T-Hook for ceiling roses
Universal Mounting Brace

Warranty

2 years "in home" covering major defects
3 Years additional covering motor only (not labour)
Remotes -1 year "in home" covering major defects. (receiver and handpiece)
Lights -1 year "in home" covering major defects

Airflow and Efficiency:

Airflow measured in Australia using the "Energy Star Solid-State Test Method", the only test method recognised For USA Energy Star compliance.

	HIGH	MED	LOW
RPMS	182	128	72
WATTS	74.8	42.5	15.8
AIRFLOW[^]: AUS-ES / USA-ES	9445 / 12751	6625 / 8944	3813 / 5148
EFFICIENCY[^]: AUS-ES / USA-ES	126.27 / 170.46	155.88 / 210.44	241.33 / 325.79

[^] Airflow measured in Cubic metres/ Hour (CM/HR), Efficiency measured in CM/HR per watt (CMH/W)

For full warranty details please see Hunter Pacific International's website www.hunterpacific.com.au

MAJESTIC RANGE CEILING FAN LIGHTING



78mm Halogen Light (MAX 100W)

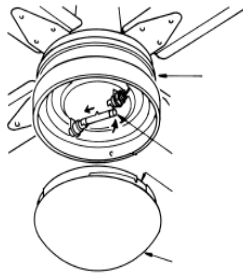

- Cost effective
- Colour—warm white
- Dimmable
- Compact in size

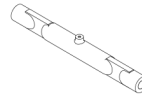

78mm linear Halogen Light globe

E27 Light (MAX 2x40W)

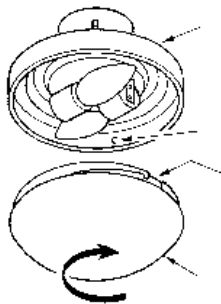

- Accepts a variety of lamps, e.g. incandescent, fluorescent.
- Cost effective
- Compatible with some CFL lamps



E27

GLACIER STYLE GLASS



ECLIPSE STYLE GLASS



Colours Available:

All light kits are available in most motor colours ~ White, White Birch, Black, Brushed Chrome, Polished Brass, Antique Brass, Burnt Copper and Stainless Steel.

GX53M 14W Compact Fluorescent Light

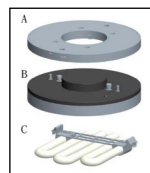
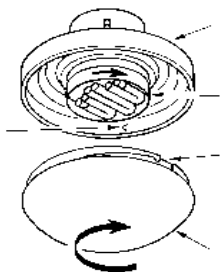

- A Base
- B Lamp Assembly
- C Tube

- Low wattage
- High light output
- Liquid mercury free
- Colour—Warm white/Cool white colour temperatures available
- Low heat
- 12000 hour life span
- 2700k or 3000k

Packaging Dimensions

17H x 25W x 25L

Weight

1.5 kg

Flat 6, 26W Fluorescent Lamp

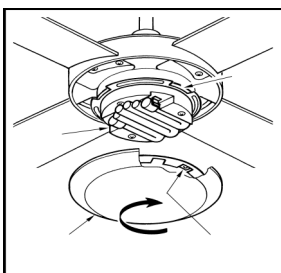

- High Efficiency (EEI=A2)
- High light output
- Liquid mercury free
- Low heat
- Fewer shadows visible
- Dimmable on certain fan models; ecO² & Ice Range (with Model 089 FLDR)
- 4100k

^ All light kits must be installed by a licensed electrician. For further information about correct installation procedures, please see www.hunterpacific.com.au

For full warranty details please see Hunter Pacific International's website www.hunterpacific.com.au